



JPK 39 FAST CRUISER



www.jpk.fr

JPK COMPOSITES

Z.A DE KERHOAS - 56260 LARMOR-PLAGE

Tél 02 97 83 89 07 - jpg.composites@wanadoo.fr

JPK 39 FC - 2025

TECHNICAL SPECIFICATIONS

LOA.....	11,72 m
Waterline length.....	0.60 m
Hull width.....	3.98 m
Draft keel	2.15 m
Draft Lift keel	1.30/1.70 m
Draft short keel.....	1.80 m
Weight.....	5600 kg
Ballast	1900 kg
Berth	6/8 persons
Headroom	1.98 m
Sail surfaces	
Mainsail	44 m²
Genoa	38 m²
Staysail	27 m²
Asymetric spinnaker	138m²

HULL AND DECK

Infused sandwich vinylester and polyester, Airex 25mm foam, quadriaxial and UD layers Construction
Airex foam infused bulkheads
Angle bars and interior elements assembled with vinylester glue and then stratified
Laminated bulkheads and interior elements with vynilester glue + stratification
Deck solid non-slip
Hull/Deck assembly with vinylester glue
Davits and peak for bowsprit

KEEL

Fixed keel: Draft 2.15 m
Cast iron fin with integrated sole, lead bulb;
T-shaped keel to optimize the center of gravity and drift

Lift keel: Draft 1.30m/2.70m
Infused composite fin
Lead within the composite
Horizontal jack with safety system

RUDDER

Twin rudder
Sandwich + unidirectional fiberglass construction – HR stainless Steel shaft

TILLER AND SYSTEM

Dual tiller with tiller extension
Carbon composite construction
Complete JP 3 system with level self-aligning roller bearings
Tie rods with adjustments

HATCHES

1 windscreen (smoked altuglass 15 mm) on the front of the roof
2 zenithal 10 mm altuglass hatches – hatch space moulded into roof
1 front opening hatch
2 roof hatch opening
2 hatch in rear cabin on both sides
6 fixed hull portholes

DECK HARDWARE

All Maneuvers / tuning can be performed from the cockpit
4 mooring cleats
2 chainplates
Bow pulpit - Pushpit
guardlines - 8 stanchions
3D genoa tuning system
2 genoa winches ST 46
2 piano winches ST 40
2 mainsail winches ST 35
Mainsail rail with central console
12 spinlock blocker (piano) for halyards and reefs - 1 XTS blocker for asymetric spinnaker tack
8 base mast blocks
2 Winch crank
2 deck blocks
2 course compass fitted on bulkhead
1 offset Bow roller

9/10TH RIGGING

Anodised aluminum black mast and boom
Installed on deck with compression post inside the main cabin
2 spreaders
boom vang
Windex wind vane
Electrical wiring
Option: AXXON Carbon mast
Option: AXXON Carbon Boom

STANDING RIGGING

Shrouds and forestay with monotoron(1 x 19 strand) and crimped terminations
Bridle textile backstay with blocker and return to winch
Option : textile staysail forestay with piano return or fixed forestay and furler
Option: ROD and dyform

RUNNING RIGGING

Molded spectra mainsail halyard
Spectra Genoa halyard
Spectra spi halyard
Mainsheets and jibsheets
3 reef furling lines
Option:
Stallsail halyard
second Gennaker or spinnaker halyard

BOWSPRIT

Pre-impregnated carbon manufactured in autoclave
System embedded in the molded peak
Bobstay

SALOON ON PORT SIDE

U-shape ergonomic seating based on a full counter mould
table attached to the central piece of furniture
Open storage space behind seating
ceiling lights – compartments
Option: 3 cabins and bathroom in the saloon

CENTRAL PIECE OF FURNITURE

Separation between saloon and kitchen
Storage piece of furniture or lift keel storage

KITCHEN

alongside starboard
lower cabinet in infused composite, high cabinet made wood
with veneer in maple
Oven, refrigerator, pressurized hot water
Double sink
Storage space
Option: drawer refrigerator

NAVIGATOR'S CORNER

Starboard side chart table with ergonomic seating and
elevated surveillance position
Under-table storage compartment
Reclined instrument panel

FRONT CABIN

Double bed 2.10 m x 1.80 m
Storage elements on port and starboard sides
trunk under bench
Crash box
Port/Starboard closet and wall cupboard
shelf at berth bottom

AFT CABIN (PORTSIDE)

Double bed 1.95 m x 1.50 m
trunk – closet
Lateral open storage
shelf at berth bottom

BATHROOM

Infused sandwich composite furniture
Shower with bilge pump - basin
Storage Furniture
Black water tank

TECHNICAL AREA

and spare cabin
Access zone to technical equipments
Option: articulated berth
Option: double mattress support
Option: full starboard cabin

COMPANIONWAY

infused composite 3 steps block sheltering engine and
batteries

INTERIOR LIGHTING

6 ceiling lights in saloon and kitchen + 2 wall lights
1 chart table wall light
2 wall lights in both aft cabin and technical area
1 wall light in bathroom
2 wall lights in front cabin

ELECTRICITY

1 x 75 A/H engine battery
2 x 105 A/H service batteries
Led Course and Top lights on mast head
Anchor lights
14-function electrical panel on opening hatch next to the
chart table

PLUMBING / SECURITY

2 x 180 L water tanks
1 x 90 L diesel fuel tank (option for a second 90 L tank)
1 electric bilge pumps
1 hand bilge pump
1 electric shower pump

ENGINE

Volvo Saildrive 30 hp + peripheral
2-blade folding propeller
Soundproofed compartment
Option: Yanmar 38 hp

CHAIN LOCKER

Locking side trap
Windlass area
Staysail forestay fitting
Offset Bow roller

HULL COLOUR

White
Option: other colours (transfer or gelcoat)

PRIX

Fixed Keel

261 607,5 € excluding VAT

Swinging Keel

288 102,5 € excluding VAT



JPK 39 FAST CRUISER



www.jpk.fr

JPK COMPOSITES

Z.A DE KERHOAS - 56260 LARMOR-PLAGE

Tél 02 97 83 89 07 - jpg.composites@wanadoo.fr

JPK 39 FC - 2025

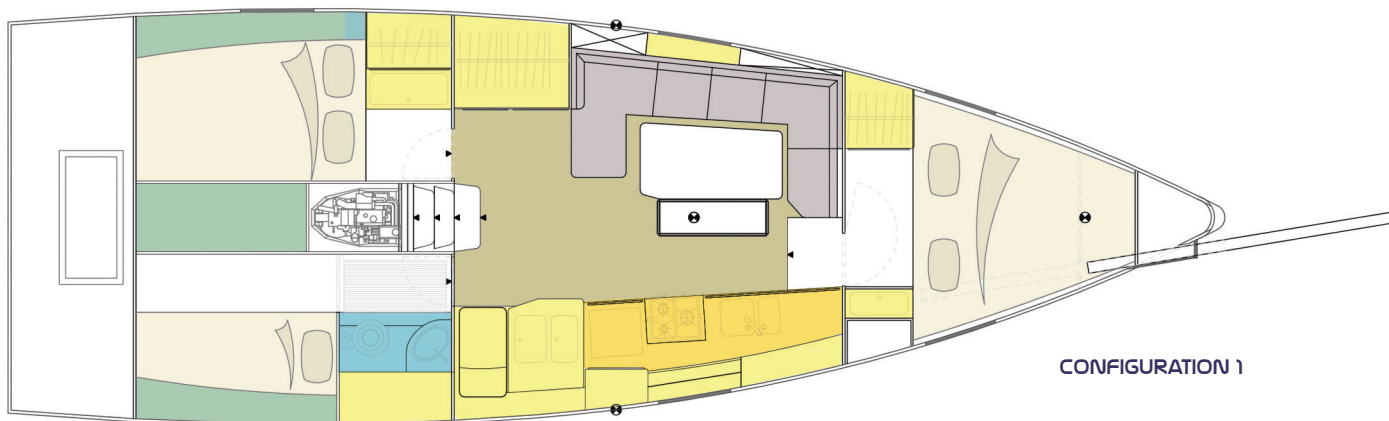

CONFIGURATION 1

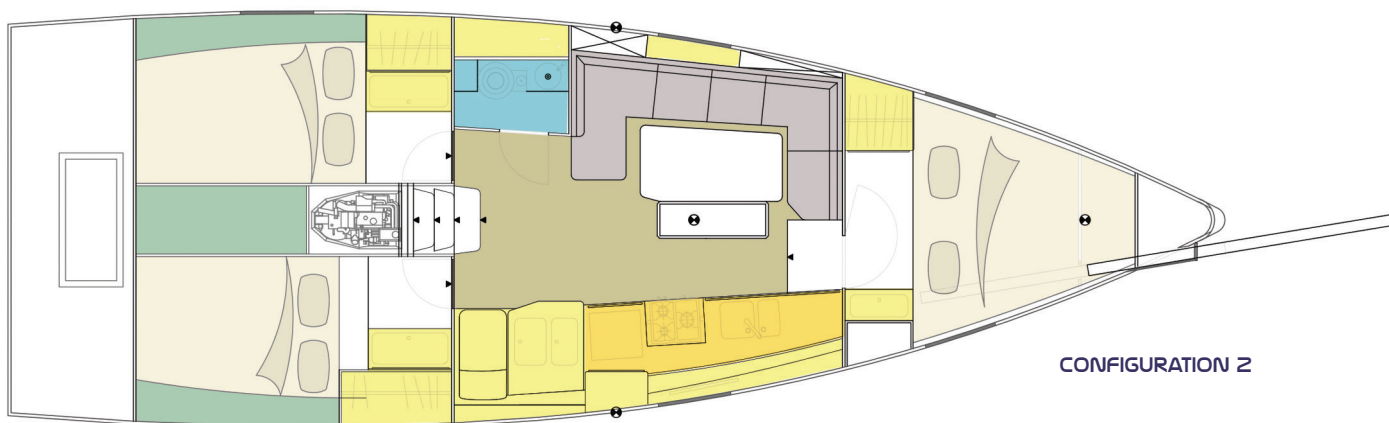

CONFIGURATION 2